

Bottom Line...

**You'll prefer Michelin®.
We'll bet your old tires on it.**



Try them for 90 days. If you're not completely satisfied, we'll replace them.*

How certain are we that once you try a set of MICHELIN® STABIL'X® XZM™ or MICHELIN® XZR™ radial tires, you'll prefer them to your bias-ply or solid tires? We're so certain we'll guarantee that if you aren't completely satisfied with the MICHELIN® STABIL'X® XZM™ or MICHELIN® XZR™ radial tire experience after 90 days, we'll replace them free of charge*. You can't lose.

Engineered with Michelin® radial technology, the MICHELIN® STABIL'X® XZM™ or MICHELIN® XZR™ tires feature robust steel casing and belts and optimized tread to help provide exceptional protection and maximized uptime. The MICHELIN® STABIL'X® XZM™ or MICHELIN® XZR™ tire offers durability, superb stability and excellent payload and equipment protection. That's a combination hard to find with bias-ply or solid tires.

*See back page
for details.



MICHELIN® XZR™

MICHELIN® STABIL'X® XZM™



MICHELIN® STABIL'X® XZM™ MICHELIN® XZR™

- Fewer flat tires for maximized uptime
- Exceptional treadwear
- Excellent stability and operator confidence
- Outstanding machine and payload protection

The rugged pneumatic MICHELIN® radial tires are designed for forklift trucks and other industrial equipment used in heavy-duty applications.

SIZE	TREAD DEPTH	
STABIL'X® XZM™	32nds	MM
5.00R8	30	24
6.00R9	31	25
6.50R10	34	27
7.00R12	35	28
7.00R15	37	29
7.50R15	38	30
8.25R15	42	33
225/75R15	34	27
250/70R15	35	28
315/70R15	44	35
355/65R15	44	35
XZR™		
6.00R9	10	12
7.00R12	14	11

MICHELIN® Tubeless Bead Seal™ (TBS™):

Who says you can't get durability and a smooth ride from the same tire?

To help ensure long tire life and improved uptime, the MICHELIN® STABIL'X® XZM™ or MICHELIN® XZR™ tire can be fitted with the MICHELIN® Tubeless Bead Seal™ (TBS™) system. The MICHELIN® TBS™ system removes the need for a tube and virtually eliminates downtime caused by punctures or tears as well as all tube-related failures and rapid deflations. Thus, the TBS™ system will help your equipment continue to run and minimize damage to your loads.

90-Day Guarantee

*Offer applies to the purchase of the MICHELIN® STABIL'X® XZM™ or MICHELIN® XZR™ radial tires. Tires to be replaced for the entire machine, no partial guarantee applies (i.e., All tires on machine must be replaced with MICHELIN® STABIL'X® XZM™ or MICHELIN® XZR™ radial tires at same time). Must be original purchaser/owner of equipment for new equipment delivery or original purchaser of tires for replacement use. Date of delivery or proof of purchase is required. Offer applies for changeover to Michelin® tires or an equivalent sized bias tire sold by an Authorized Michelin® Dealer in corresponding size only. Michelin® will credit the value of the tires and the changeover mounting fees to an Authorized Michelin® Dealer only. Dealers or customers who mount tires or own tires. No replacement of tires due to damage caused by operation (intentional or negligent), theft, or acts of God. All Michelin® Limited Warranty exclusions still apply. See Authorized Michelin® Dealer and warranty for details. (Note: Current Michelin® Earthmover, Off-the-road, and Industrial Tire Limited Warranty, Order # MEE40022 dated 7/04.) All guarantee changes must be verified through your local Michelin® Earthmover Sales Representative. MNA reserves the right to discontinue, modify and/or supplement all of the policies, terms, and/or allowances of this program effective July 21, 2010 explained above or at any time without prior notice.



MICHELIN® Radial vs. Bias-Ply

MICHELIN® X®-Radial Construction

Crown is stabilized by a belt made up of several steel plies
Strong steel radial casing



Bias-Ply Construction

Casing is made up of criss-crossed fabric plies (no steel)
Crown is not stabilized

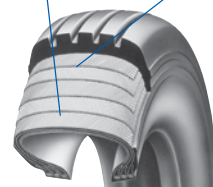

www.michelinearthmover.com
One Parkway South, P.O. Box 19001, Greenville, SC 29602-9001
1-877-574-8473

www.michelinearthmover.com
An Equal Opportunity Employer

© 2006 MNA, Inc.
MEL43028
(7/10)

